

# Making Building Easy

April 2015

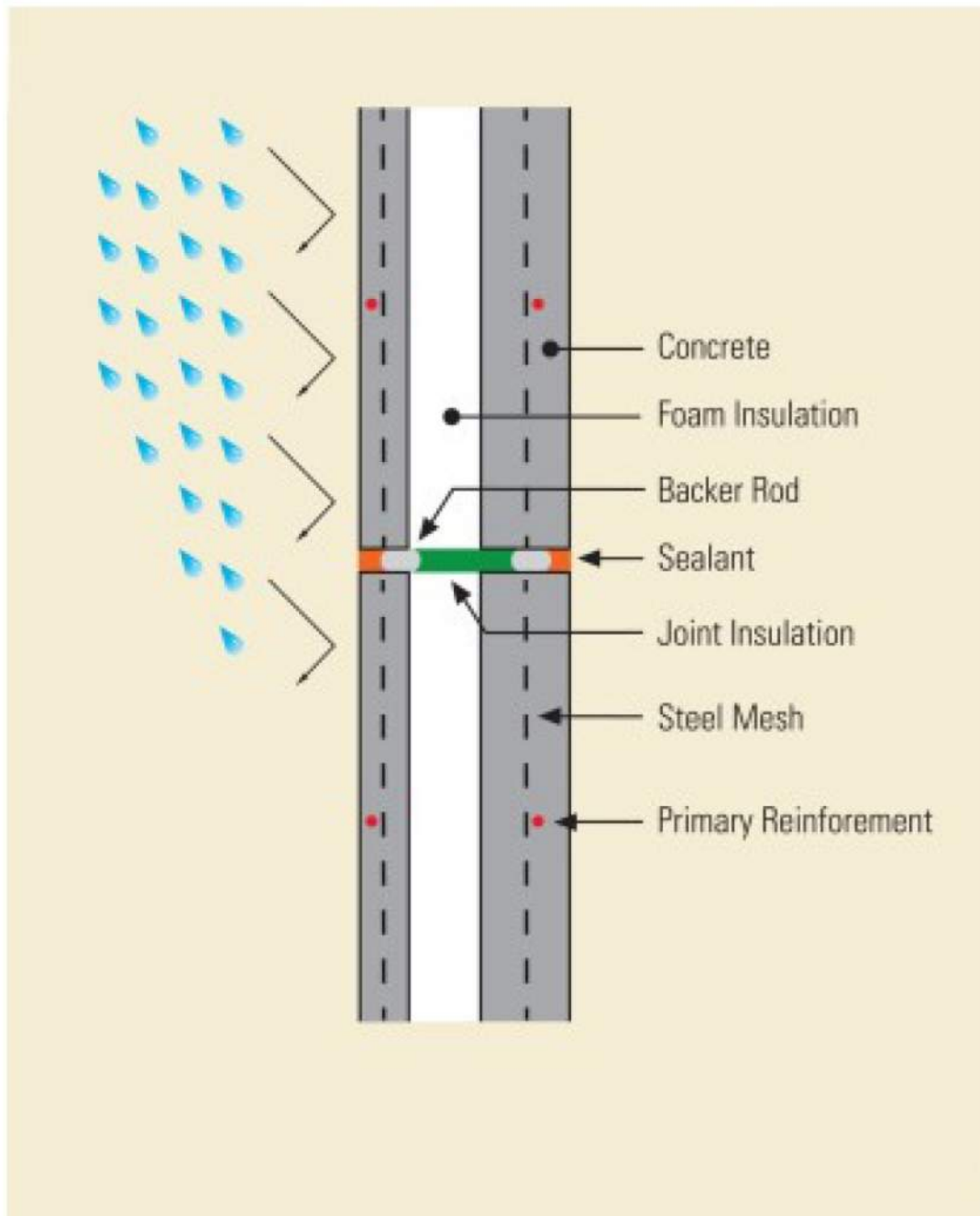

## Rain Barriers vs Rain Screens

Rain Barriers and Rain Screens In buildings, water has the unfortunate habit of getting where building owners



## AIA WI April 22-23

Join us at Booth 701

We will be providing a 15 min Expo Education Program. If you attend four of these you earn 1.0 CES credit. We will also be showing the coolest school construction video you have ever seen.

## Articles of Interest

[Instead of Complaining Remember these 10 Things](#)

[8 Traits of a Healthy Relationship](#)

[The Passive House in New York](#)

[Skinny Building with Precast](#)

[Interior](#)

don't want it to go. And once inside a building it has the potential to do significant damage.

Buildings gain, lose and store moisture along with heat energy through a variety of physical mechanisms.

Operating durability, efficiency and serviceability of the structure can be affected by moisture flow. Controlling moisture flow in a building also has significant impacts on occupant health, safety and comfort.

Modes of moisture flow into buildings include:

- **Precipitation** – rain and moisture making their way through openings in building surfaces
- **Water vapor evaporation** – liquid water changing into gaseous or vapor state and is absorbed into the air
- **Diffusion** – water vapor moving under pressure from areas of high concentration to areas of low concentration and also high temperatures to low temperatures
- **Condensation** – water changing from a vapor state to a liquid state as air becomes saturated. Where condensation occurs matters.

Architects generally have two approaches:

1. Keep moisture from penetrating the wall assembly
2. Assume it will penetrate the assembly and provide a way to remove it

[continue reading](#)

---

## Acoustical Advantages of Precast systems

The purpose of architectural acoustics is to create an environment where sounds are clearly heard by the intended listener and noise is isolated or absorbed. These are two ways of dealing with sound levels:

Podcasts

[Welcoming Challenge](#)

[How to Manage Your Mind](#)

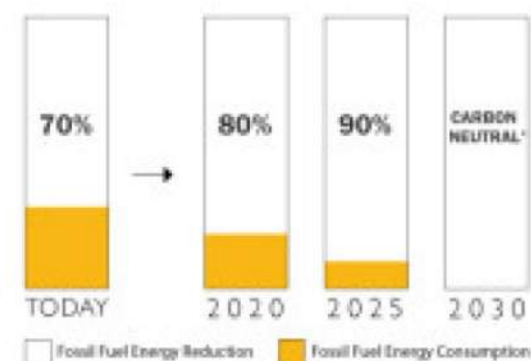

## [The 2030 Challenge](#)

Who is participating in the [2030 Challenge](#)? Email us to let us know if you are involved and what your thoughts are?



## Is the building moving?

Hempstead High School's addition contains a gymnasium, locker rooms, auditorium, a music suite and classrooms. The lower level is approximately 41,140 sf and the upper is approximately 39,100 sf.

The precast wall panels were produced with a custom formliner

sound insulation and sound absorption. Materials with a heavy mass (like concrete walls) work well with sound insulation, while porous lightweight materials work well with absorption. Sound insulation is usually more complicated than absorption.

STC (Sound Transmission Class) is a numerical rating system on how well a building partition reduces the amount of noise at a given frequency that passes through. The higher the STC, the better the performance of sound insulation.

### **STC     What can be heard**

**25**        Normal speech can be understood quite easily and distinctly through wall

**35**        Loud speech audible but not intelligible  
Onset of “privacy”

**45**        Loud speech not audible; 90% of statistical population not annoyed

**50**        Very loud sounds such as musical instruments or a stereo can be faintly heard; 99% of population not annoyed

**60+**       Superior soundproofing; most sounds inaudible

An STC rating of 50 will satisfy most building code requirements. An 8” CarbonCast panel with 4” of insulation will provide a STC rating of 52. This rating can be increased if ... [continue reading](#)

for the exterior and the interior of the auditorium. As the sun moves throughout the day the curved form lines of the walls appear to move. The interior panels of the auditorium have a custom finish that resembles a theater curtain which provides a stunning appearance and great acoustic values. [check out the project profile](#)

---

## **Coming Soon...**

**Meet Molly** - We will introduce you to one of the most important people we know!

## **Evolution of Sustainability**

---

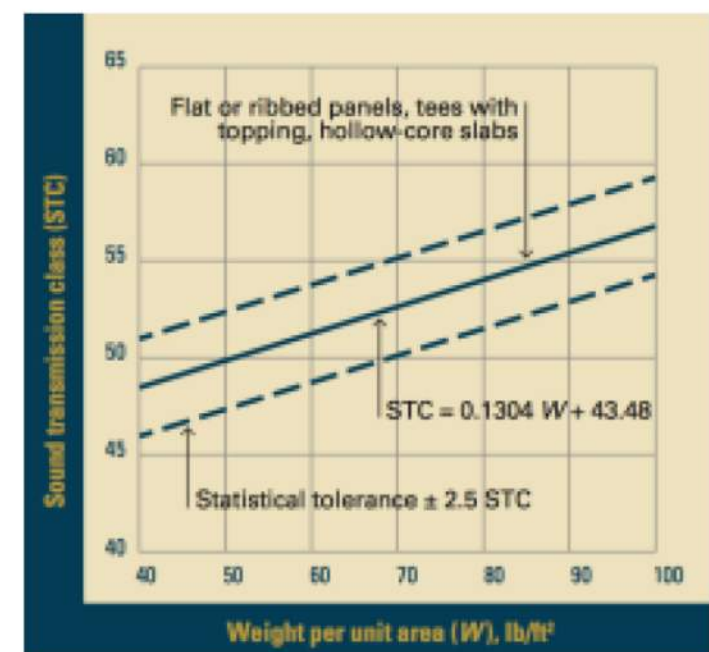

**Big results require big ambitions. -**

*Heraclitus*

---



**Jeremy Olivotti**

Vice President of Pre-  
Construction

**608-751-1474** (m)

**800-236-1072** (w)

**815-389-2339** (f)



**MID-STATES**  
CONCRETE INDUSTRIES

---

■ Website ■ Twitter ■ LinkedIn ■ Blog ■ YouTube

---

500 South Park, South Beloit, IL 61080, United States